

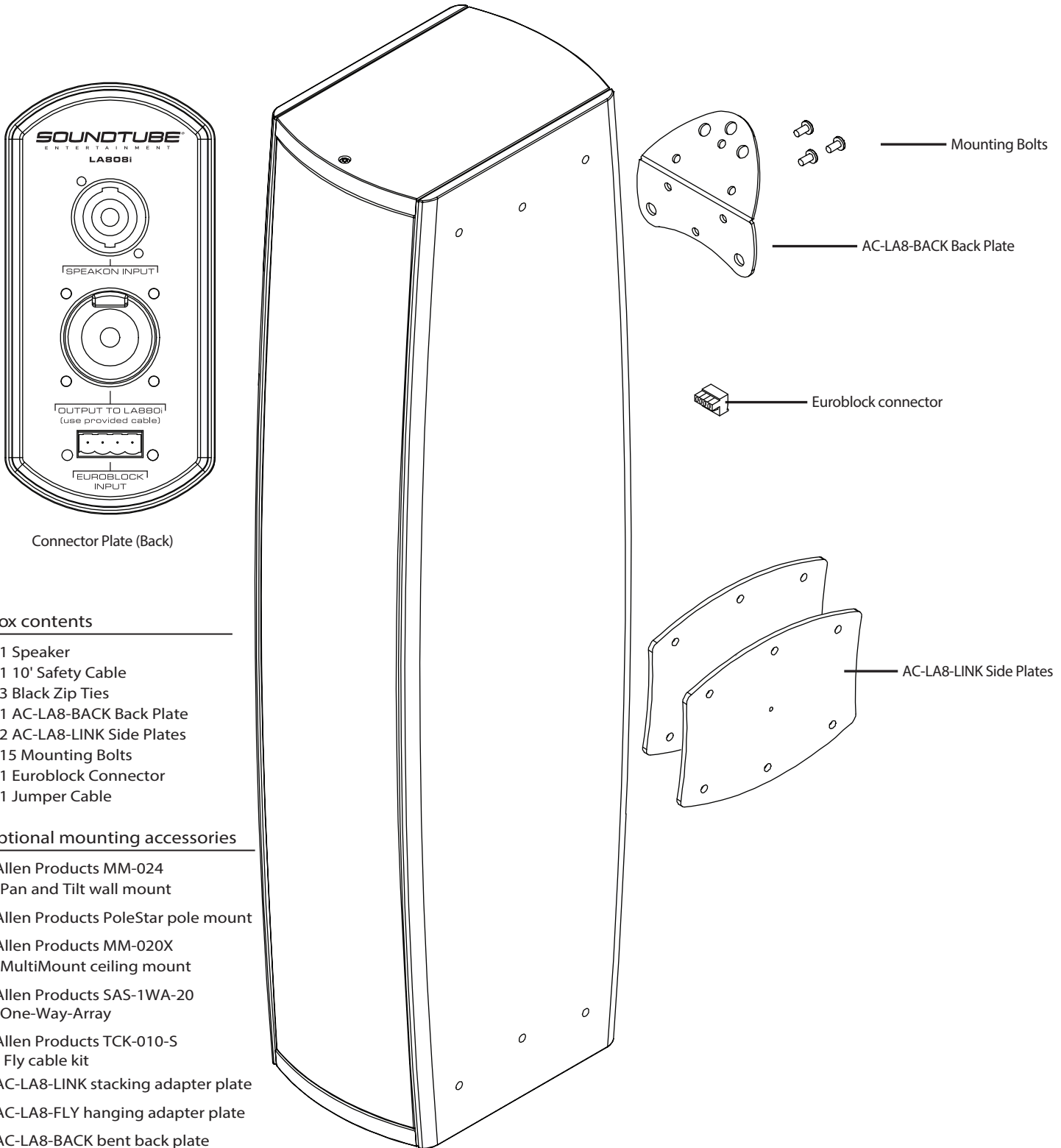

**LA808i** | Install Instructions For:  
LA808i (Low-Frequency Driver) speaker



Connector Plate (Back)

**Box contents**

- 1 Speaker
- 1 10' Safety Cable
- 3 Black Zip Ties
- 1 AC-LA8-BACK Back Plate
- 2 AC-LA8-LINK Side Plates
- 15 Mounting Bolts
- 1 Euroblock Connector
- 1 Jumper Cable

**Optional mounting accessories**

- Allen Products MM-024 Pan and Tilt wall mount
- Allen Products PoleStar pole mount
- Allen Products MM-020X MultiMount ceiling mount
- Allen Products SAS-1WA-20 One-Way-Array
- Allen Products TCK-010-S Fly cable kit
- AC-LA8-LINK stacking adapter plate
- AC-LA8-FLY hanging adapter plate
- AC-LA8-BACK bent back plate

1.435.64 7.9555 | 800.64 7.TUBE | www.soundtube.com

LA808i

© 2012 SoundTube Entertainment, Inc. All rights reserved. PN INS-LA808i Rev 08.15.12

**Warning**

SoundTube speakers must be installed by a professional audio installer/contractor. For safety and for optimum audio performance, installer must follow all directions issued by SoundTube Entertainment.

**Warning**

Do not spec or install speaker near support beam, ventilation duct or other structure that may interfere with speaker function or dispersion.

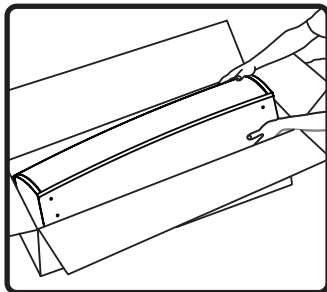

1. Unpack speaker.

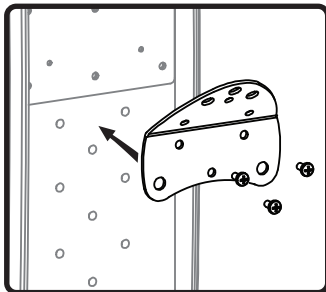

2. Using supplied bolts, attach included AC-LA8-BACK back plate to rear of speaker. **WARNING:** Do not exceed 100 in-lbs when installing bolts in threaded inserts.

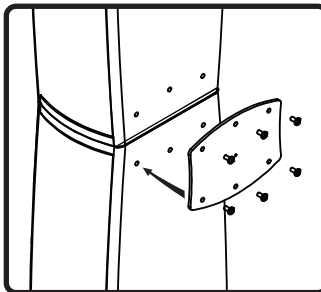

3. Set LA880i on top of LA808i and attach supplied AC-LA8-LINK side plates using supplied bolts.

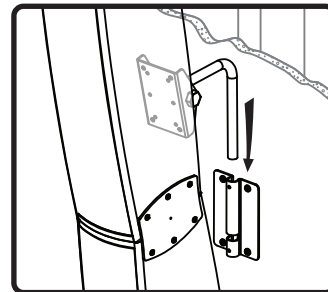

4. Mount speaker to structure using LA880i instructions and applicable Allen Products hardware.

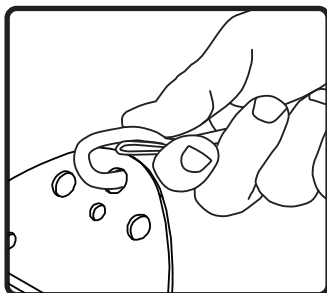

5. Attach included safety cables to each bent bracket (on LA808i and LA880i), and secure to the structure using installer supplied fasteners.

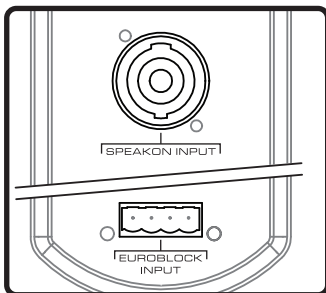

6. Choose one of two inputs: SpeakOn,™ or included Euroblock. Note: Signal wire must connect to LA808i. Do not connect signal wire directly to LA880i.

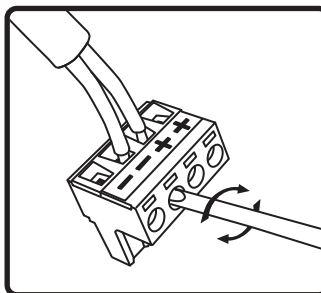

7. If using Euroblock input, connect signal wire to four-pin Euroblock plug. If using SpeakOn connector skip to step 10.

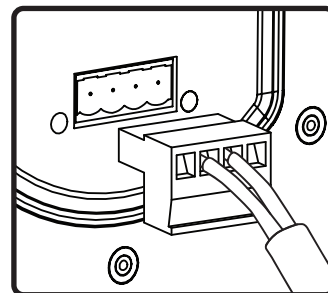

8. Insert wired 4-pin Euroblock jack into speaker. Connectors are keyed for polarity. Skip to step 11.

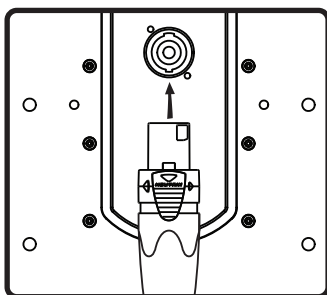

10. If using SpeakOn cable, insert the end of the cable into the SpeakOn input connector, and twist to lock.

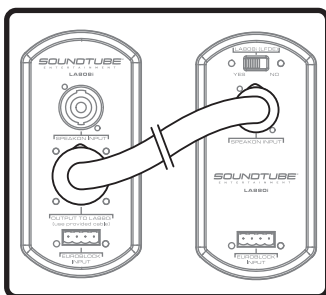

10. Connect included jumper cable from LA808i output to LA880i SpeakOn input. Jumper cable passes the proper signal from LA808i to LA880i for maximum performance.

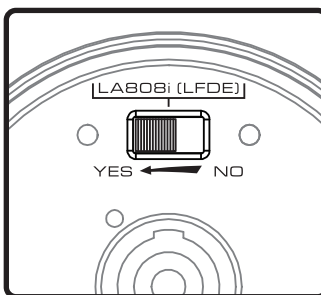

11. Flip LFDE switch on LA880i to "YES". Failure to flip the switch will negatively impact sound quality.

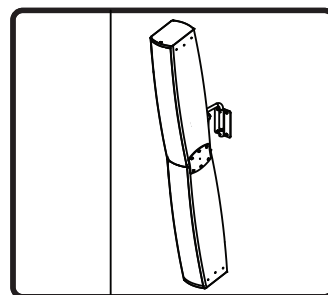

12. Done!

**NOTE:** To further constrain the low frequency beamwidth, two LA808i LFDE units may be used. In this case mount one LA880i between the two LA808i units. Wire one LA808i and the LA880i as described above. Feed the other LA808i the same full range signal, but from another amplifier channel. Do not wire the two units in parallel unless the amp is 2 ohm stable.